

# HabasitLINK<sup>®</sup> M2533 GripTop 1"



Your Source For Habasit  
Belting And Chain

www.StilesEnterprises.com • 1-800-325-4232

## Description

- Open area dependent on percentage of GripTop modules installed, as illustrated approx. 20%
- Food approved materials available
- Abrasion resistant GripTop, high friction
- Rubber hardness: 50 shore A
- Rod diameter 5 mm (0.2")
- "Open window" sprockets

## Proposed pattern

- Indent 50 mm (2")
- GripTop rows every 2nd, 4th, 6th module row (multiples of 50.8 mm (2"))

## Available accessories

- Flights
- Hold down devices

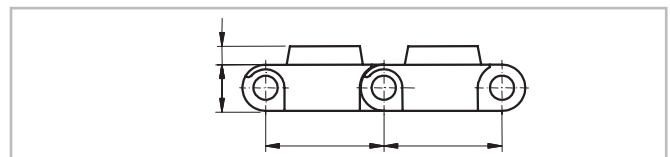
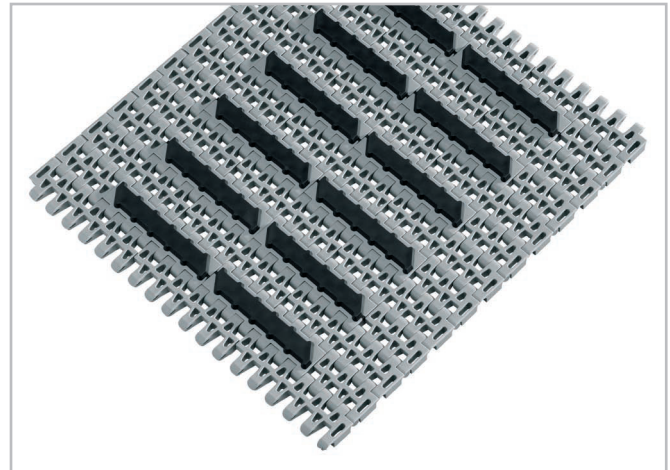

## Belt data

Belt material		PP				POM	
GripTop material		TPE					
Rod material		PP	POM	PP	POM	PP	PA
Nominal tensile strength F <sub>N</sub> straight run	N/m	14000	14000	14000	14000	18000	22000
	lb/ft	959	959	959	959	1233	1507
Temperature range	°C	5 - 60	5 - 60	5 - 60	5 - 60	5 - 60	-40 - 60
	°F	40 - 140	40 - 140	40 - 140	40 - 140	40 - 140	-40 - 140
Belt weight m <sub>B</sub>	kg/m <sup>2</sup>	6.5	6.5	6.5	6.5	9.3	9.3
	lb/sqft	1.34	1.34	1.34	1.34	1.91	1.91
Standard belt color		grey	grey	white	white	blue	blue

Diameter of idling rollers (minimum)		Diameter of support rollers (minimum)		Diameter for gravity take-up and center drive rollers (minimum)		Backbending radius for elevators without side guards or hold down devices (minimum)		Backbending radius for elevators with sideguards or hold down devices (minimum)	
mm	inch	mm	inch	mm	inch	mm	inch	mm	inch
40	1.6	50	2	100	4	150	6	250	10

Use the largest possible backbending radius for elevators with side guards or hold down devices.

## Standard range of belt widths b<sub>0</sub>

mm (nom.)	200	300	400	500	600	700	800	900	1000	1100	1200	1300	1400	1500	etc.
inch (nom.)	8	12	16	20	24	28	32	36	40	43	47	51	55	59	etc.

Real belt widths are in most cases 0.1% to 0.3% smaller.

Standard belt widths in increments of 50 mm (2"). Non-standard widths are offered in increments of 16.66 mm (0.66"), minimum indent 33.3 mm (1.5").

For detailed material properties refer to the HabasitLINK<sup>®</sup> Engineering Guidelines or contact your Habasit representative.

The nominal tensile strength is valid for 23 °C (73 °F). The admissible tensile force depends on the operating temperature near the drive sprockets. Within the temperature range allowed, the admissible tensile force may vary from 100% to 20% of the nominal tensile strength. For detailed information and correct calculation of effective tensile force refer to the Calculation Guide in the HabasitLINK<sup>®</sup> Engineering Guidelines.